



3CUA

Threaded Brass Swing Check Valves



Features and Benefits

- Widely used in fluid control systems.
- Applied in water supply, irrigation, heating.
- Limited spaces, such as well covers and base-ments .
- Easily installed with female threaded ends.

Material list

1	Body	Brass CW617N
2	Cap	Brass CW617N
3	Disc	Brass CW617N
4	Gasket	PTFE
5	Pin	Stainless Steel SUS304
6	Nut	Stainless Steel SUS304

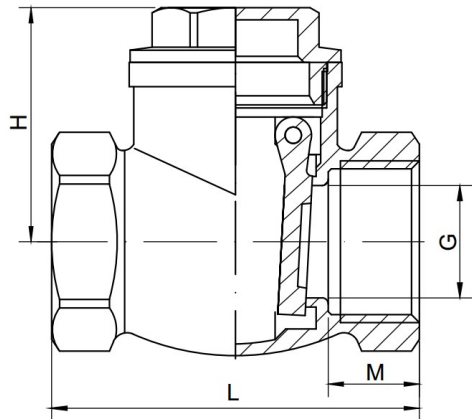

Specifications

Type	Swing check valve
Size	1/2" to 2"
Pressure	16 bar
Temperature	80°C
Connection	ISO 228-1 female thread